



Spectacular View Condo at Park 360
2906 - 7088 18th Avenue • Burnaby, BC

RESIDENT EXPERTS
ENGEL & VÖLKERS



Key Facts & Features

- Price: \$489,000
- Total Bedrooms: 1
- Total Bathrooms: 1
- Home: 598 sq.ft.
- Built in 2007
- Taxes: \$2146.91 (2019)
- Maintenance Fee: \$206.87
- Pets Allowed With Restrictions
- Rentals Allowed With Restrictions
- Amenity Room, Exercise Room, Whirlpool, Sauna, Steam Room
- Playground
- School Catchments: Stride Ave Elementary and Byrne Creek Secondary
- Neighbourhood: Edmonds



Stunning Unobstructed Southeast Views

Welcome to Park 360, a central development located within Burnaby East just steps from the Edmonds Skytrain station. Stunning, unobstructed southeast views of Burnaby Mountain, the Fraser River and New Westminster. A beautiful, well appointed and functional one bedroom apartment featuring a spacious balcony, 1 parking, 1 storage locker and plenty of in suite storage. Enjoy the morning sunrise from the comfort of the bedroom, balcony or curl up to a good book and views around the cozy fireplace. Walking distance to Poplar Park, Stride Avenue Park, Ernie Winch Park and Byrne Creek Urban Trails. Stride Ave Elementary, Byrne Creek Secondary and Highgate Shopping Centre are just a few blocks away. Don't miss out on this fantastic investment opportunity!

2906 - 7088 18th Avenue • Burnaby, BC



1 bedroom + 1 bathroom

Total Interior: 598 sq.ft.

Balcony: 82 sq.ft.

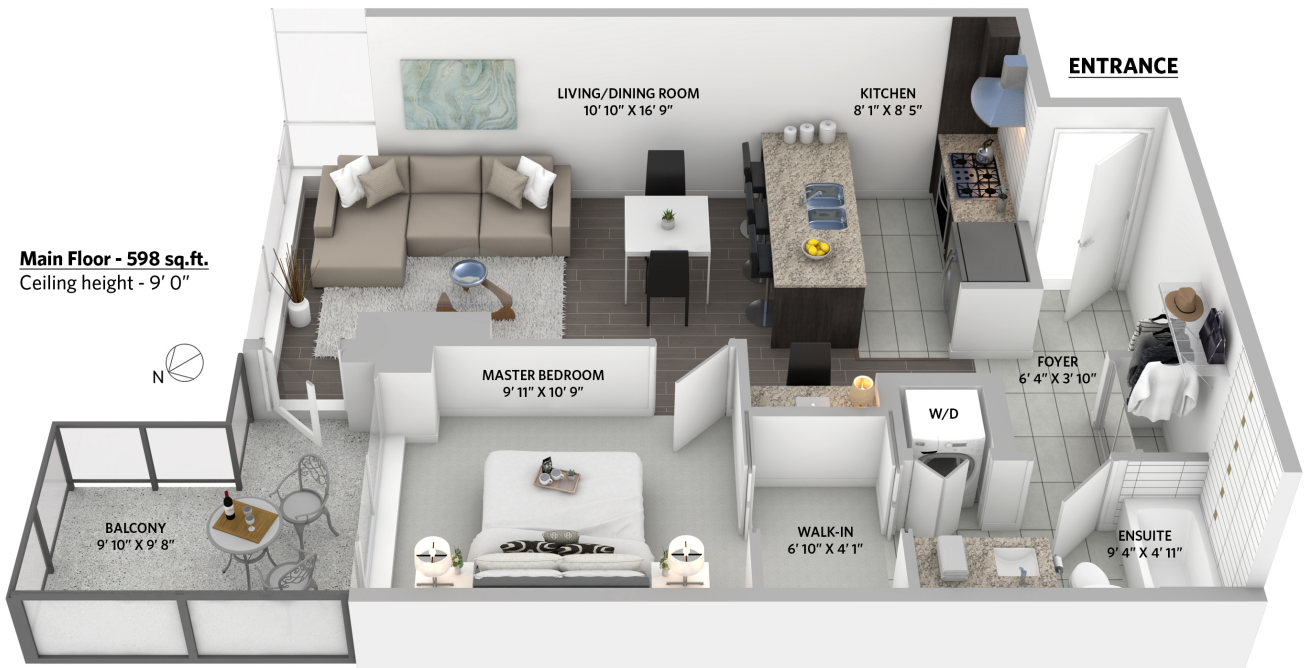

*Measurements are approximate. Buyer to verify if important.



Carla Craig
PERSONAL REAL ESTATE CORPORATION
C: 604.996.1146 • E: carla@residentexperts.ca

Scott Regamble
PERSONAL REAL ESTATE CORPORATION
C: 604.802.5917 • E: scott@residentexperts.ca

Amanda Crosby Regamble
PERSONAL REAL ESTATE CORPORATION
C: 604.802.1091 • E: amanda@residentexperts.ca

Engel & Völkers Vancouver • 130-1152 Mainland Street, Vancouver, BC • residentexperts.ca

RESIDENT EXPERTS

ENGEL & VÖLKERS